

Series TG, TGR and FTG



Two-shell wood loading grabs

TG2

Excavator weight class (t): 8-14

Speed (rpm): 12

Load bearing capacity (t): Grab: 5 / Slewing gear: 5

Log length (m): 6

Operating pressure (bar): 250 grabbing / 250 slewing

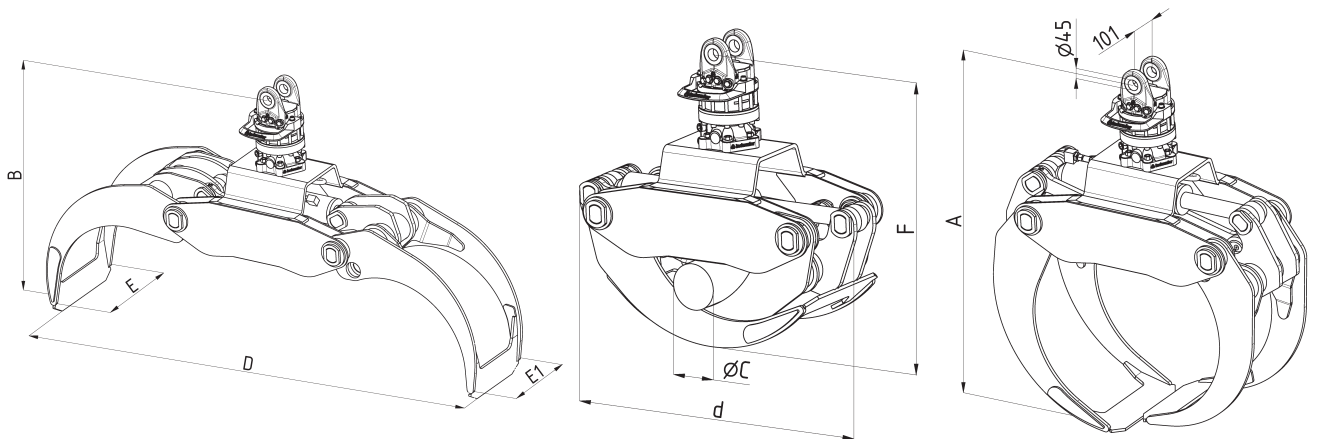

Type	Capacity (m ²)	Weight (kg)	Dimensions (mm)						
			A	B	C	d	D	E/E1	F
TG2-300	0.3	372	1325	1110	110	970	1890	480/410	975
TG2-400	0.4	455	1355	1140	150	1085	2005	530/460	985
TG2-500	0.5	485	1429	1180	180	1145	2145	530/460	1010





Connecting piece for cardanic grab suspension

Continuously rotatable hydraulic slewing gear

Hose protection bar for the hose connections

- Straps HB 450
- Side parts S 690 QL
- Bottom edge HB 500

Synchronized control run arranged protected in the arm

Lubrication points easy to access



Handling grab for logs and round timber. Due to the shape of the tines, TG2 wood grabs can easily pick up one or more logs of different diameter from the ground, a stack or HGV and confidently hold and handle them.